

ALL WEATHER HIGH SPEED DOORS

CRASH FORGIVING & AUTOMATICALLY RE-INSERTING



ALL WEATHER
HIGH SPEED DOORS

**Designed for exterior use,
with storm force wind exposure.**

*DYNACO is a unique “patented” concept offering:
The safest, fastest, best sealing doors, with the
lowest maintenance cost in the industry.*



ALL WEATHER M2 Designed for exterior environments.

Resists and operates under pressures up to:

Maximum dimensions: W 18' x H 18'

Width (ft.)	UP TO 7'	8'	9'	10'	11'	12'	13'	14'	15'	16'	17'	18'
Pressure (lbs./sq.ft.)	88.78	77.68	69.05	62.14	56.49	51.79	47.80	44.39	41.43	38.84	36.56	34.52
Wind speed* (mph)	185	170	162.5	150	145	140	135	130	125	122.5	120	115

*Wind speed is indicative, not including any multiplication coefficients taking into account the configuration of the building.

DESCRIPTION

STANDARD OPERATING SPEED: 48"/sec. Optional speeds up to 96"/sec. upon request depending on door size.

OPERATING TYPE: gear driven, push-pull movement.

SIDE GUIDE made of structural channels of 3 1/8" x 1 5/8" x 1/8" in galvanized steel.

INNER SIDE GUIDE in polyethylene (PE-UHMW 1000); outer section 7/8" x 1 9/16", on springs. Galvanized side covers included.

DRUM in steel, diameter 4" x 0.078", shafts in steel.

DOOR CURTAIN in reinforced PVC (27 oz/sq. yd). Available in different colors and provided with side sealing zippers; soft bottom edge design.

MOTOR without brake, with 4 poles, controlled by a variable speed drive. Power: 1 HP for a door surface up to 18 sq.yds; 2 HP (larger surface).

Protection degree NEMA 4.

GEARBOX size 50 for a motor of 1 HP and gear reduction ratio 1/7; size 63 for 2 HP.

DETECTORS: An infrared photocell installed inside the side guide and detecting the presence of a pedestrian or a vehicle. Upon activation, it opens the door immediately and keeps it open as long as the presence is detected. Height of the photocell: 12" from the floor. (Optional: up to maximum 24" from the floor).

A bottom edge detector opens the door when it hits an obstacle during the closing cycle. This detector is positioned at the bottom part of the curtain.

POWER SUPPLY: Standard: single phase 208-230 VAC, three phase 208-230 VAC, three phase 460 VAC. Optional: three phase 575 VAC.

Frequency: 50-60 Hz. Circuit breakers to be provided by the customer: 10A for a motor of 1 HP and 16A for 2 HP.

SPACE REQUIREMENTS: All indicated dimensions are net: the

additional space necessary for mounting and maintenance has to be taken into account. Reduced dimensions upon request.

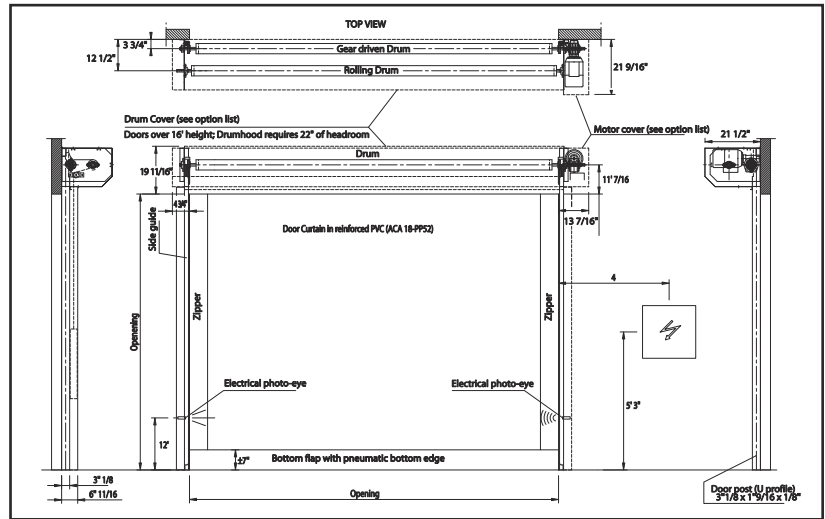

ALL WEATHER M3 Designed for exterior environments.

Resists and operates under pressures up to:

Maximum dimensions: W 39' x H 18'

Width (ft.)	UP TO 19'	20'	21'	23'	25'	27'	29'	31'	33'	35'	37'	39'
Pressure (lbs./sq.ft.)	32.71	31.07	29.59	27.02	24.86	23.03	21.43	20.05	18.83	17.76	16.80	15.93
Wind speed* (mph)	110	107.5	105	100	97.5	95	90	87.5	85	82.5	80	77.5

*Wind speed is indicative, not including any multiplication coefficients taking into account the configuration of the building.

DESCRIPTION

STANDARD OPERATING SPEED: 31.2"/sec.

OPERATING TYPE: gear driven, push-pull movement.

SIDE GUIDE made of structural channels of 3 15/16" x 2" x 1/8" in galvanized steel.

INNER SIDE GUIDE in polyethylene (PE-UHMW 1000); outer section 7/8" x 1 9/16", on springs. Galvanized side guide covers included.

DRUM in steel, diameter 5 1/2" x 1/8", shafts in steel.

DOOR CURTAIN in reinforced PVC (27 oz/sq.yd). Available in different colors and provided with side sealing zippers; soft bottom edge design.

MOTOR without brake, with 4 poles, controlled by a variable speed drive. Power: 2 HP for a door surface up to 44 sq.yds; 3 HP (larger surface).

Protection degree NEMA 4.

GEARBOX size 63 for a motor of 2 HP and gear reduction ratio 1/15; size 90 for 3 HP.

DETECTORS: An infrared photocell installed inside the side guide and detecting the presence of a pedestrian or a vehicle. Upon activation, it opens the door immediately and keeps it open as long as the presence is detected. Height of the photocell: 12" from the floor. (Optional: up to maximum 24" from the floor).

A bottom edge detector opens the door when it hits an obstacle during the closing cycle. This detector is positioned at the bottom part of the curtain.

POWER SUPPLY: Standard: single phase 208-230VAC, three phase 208-230 VAC, three phase 460 VAC. Optional: three phase 575 VAC.

Frequency: 50-60 Hz. Circuit breakers to be provided by the customer: 16A for a motor of 2 HP and 25A for 3 HP.

SPACE REQUIREMENTS: All indicated dimensions are net: the

additional space necessary for mounting and maintenance has to be taken into account. Reduced dimensions upon request.

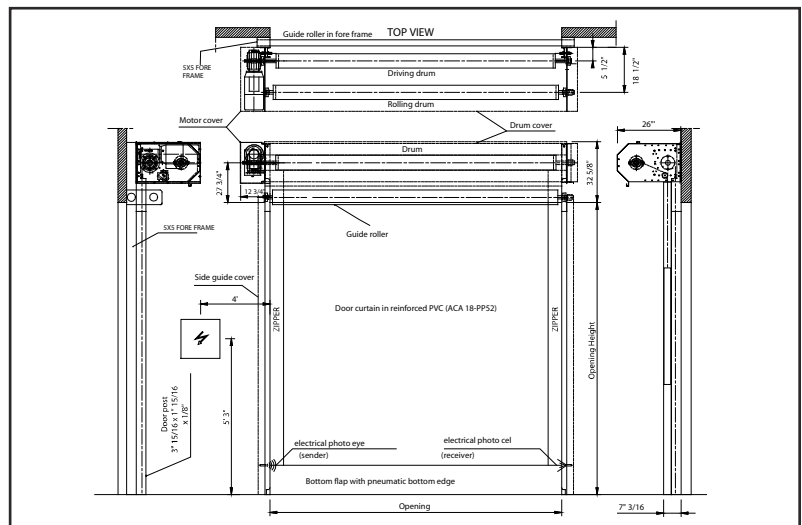

Within the framework of its policy of continuous development of its products, DYNACO reserves the right to modify the characteristics of its products and parts without prior notice.



The Leader in Door Safety and Design



DYNACO USA Order Form

DYNACO ALL WEATHER M3 DOOR

TECHNICAL INFORMATION	<u>Door location:</u>		<u>Motor side:</u> Ed01 <input type="checkbox"/> Left Ed02 <input type="checkbox"/> Right		
	Door size: Width: _____ft_____In Height: _____ft_____In Head room clearance: _____ft_____In Special instruction: _____	<u>Power:</u> Fd01 <input type="checkbox"/> 1 x 208V Fd01 <input type="checkbox"/> 1 x 230V Fd02 <input type="checkbox"/> 3 x 208V Fd02 <input type="checkbox"/> 3 x 230V Fd03 <input type="checkbox"/> 3 x 460V Fd04 <input type="checkbox"/> 3 x 575V+Line Load Reactor		<u>Color:</u> Ee00 <input type="checkbox"/> Brown Ee01 <input type="checkbox"/> Grey Ee02 <input type="checkbox"/> Red Ee03 <input type="checkbox"/> Green Ee04 <input type="checkbox"/> White Ee05 <input type="checkbox"/> Yellow Ee06 <input type="checkbox"/> Blue Ee07 <input type="checkbox"/> Orange Ee08 <input type="checkbox"/> Black	
			<u>Special Curtain request:</u> Fi17 <input type="checkbox"/> Logo		

MECHANICAL	<u>Covers:</u> <input type="checkbox"/> Side guide cover galvanized (St) <input type="checkbox"/> Side guide cover powder coat <input type="checkbox"/> Motor cover galvanized <input type="checkbox"/> Motor cover powder coat <input type="checkbox"/> Drum cover galvanized <input type="checkbox"/> Drum cover powder coat	
	<u>Vision:</u> <input type="checkbox"/> _____Individual window(s) <input type="checkbox"/> _____Window banner(s) <input type="checkbox"/> _____Bug screen window(s) <u>Positioning:</u> First row: Ee09 <input type="checkbox"/> Custom height: _____ Multiple rows: Ee10 <input type="checkbox"/> Heights: _____ft & _____ft & _____ft	

ELECTRICAL	<u>Control box type:</u> Fg04 <input type="checkbox"/> Steel Fg02 <input type="checkbox"/> Stainless Fg07 <input type="checkbox"/> Custom: _____	
	<u>Photocell (in side guide):</u> <input type="checkbox"/> Standard height (12") Ef01 <input type="checkbox"/> Other height: _____ft Fi01 <input type="checkbox"/> Additional photocell – Height: _____	
	<u>Electrical options:</u> Fi01 <input type="checkbox"/> Additional photocell Fj12 <input type="checkbox"/> Info door open Fj13 <input type="checkbox"/> Info door closed Fj01 <input type="checkbox"/> Airlock/Interlock Fh03a <input type="checkbox"/> Flashing light Fj18 <input type="checkbox"/> Delay before opening Fj24 <input type="checkbox"/> Info door running Fgx <input type="checkbox"/> Extended cable: _____ft Fj04 <input type="checkbox"/> Traffic lights Fj19 <input type="checkbox"/> Delay before closing Fj12 <input type="checkbox"/> Info door not open	

REMOTE ACTIVATION	G11 <input type="checkbox"/> Open push button G17 <input type="checkbox"/> Mushroom Button G25 <input type="checkbox"/> Open/close/stop button	
	<u>Radar:</u> G56 <input type="checkbox"/> Falcon (Nema 4) G54 <input type="checkbox"/> Bracket in galvanized steel G57 <input type="checkbox"/> Remote control (BEA) G55 <input type="checkbox"/> Bracket in stainless steel	
	<u>Remote Control:</u> G41 <input type="checkbox"/> Receiver G42 <input type="checkbox"/> 1 channel transmitter G43 <input type="checkbox"/> 2 channel transmitter G44 <input type="checkbox"/> 4 channel transmitter	
	<u>Other Commands:</u> G61 <input type="checkbox"/> Loop detector	

REMARKS	
----------------	--

Within the framework of its policy of continuous development of its products, DYNACO preserves the right to modify the characteristics of its products and parts without preceding notice.

DYNACO. THE SAFEST CHOICE

DYNACO USA, Inc
3175 Mac Arthur Blvd.
Northbrook, IL 60062

Tel. (847) 562-4910 Fax (847) 562-4917
Web: www.dynacodoor.us
E-mail : dynaco@dynacodoor.us



DYNACO USA Order Form

Customer:

Door Reference:

Production Number:

GENERAL INFO

Invoice address (customer or DYNACO Dealer) :

COMPANY: Phone:
Contact name: Fax:
Address:
City: State: Zip Code:

END USER INFO

End user (if not the same as the invoice address) :

COMPANY: Phone:
Activity:
Contact name: Fax:
Address:
City: State: Zip Code:

DELIVERY INFO

Delivery address (if not the same as the end user address) :

COMPANY: Phone:
Contact name: Fax:
Address:
City: State: Zip Code:

INSTALLATION

Installation (if not by DYNACO Dealer) :

COMPANY: Phone:
Contact name: Fax:
Address:
City: State: Zip Code:

TIMING

Expected installation date:

Expected delivery time:

Within the framework of its policy of continuous development of its products, DYNACO preserves the right to modify the characteristics of its products and parts without preceding notice.

DYNACO. THE SAFEST CHOICE

DYNACO USA, Inc
3175 Mac Arthur Blvd.
Northbrook, IL 60062

Tel. (847) 562-4910 Fax (847) 562-4917
Web: www.dynacodoor.us
E-mail : dynaco@dynacodoor.us